

NATR17-X

Yoke type track roller

Schaeffler ID:
0000344870000

Yoke type track rollers NATR, with axial guidance, gap seals on both sides

Technical information

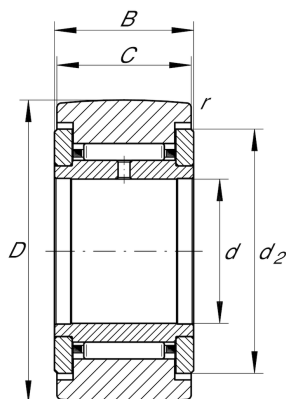

Main Dimensions & Performance Data

d	17 mm	Bore diameter
D	40 mm	Outside diameter
B	21 mm	Width, inner ring
$C_{r w}$	10,900 N	Basic dynamic load rating, radial
$C_{0r w}$	16,000 N	Basic static load rating, radial
$C_{ur w}$	2,130 N	Fatigue load limit, radial
n_{DG}	2,900 1/min	Speed on permanent grease lubrication
$F_{0r per}$	16,000 N	Permissible static load, radial
$F_{r per}$	16,000 N	Permissible dynamic load outer ring, radial
	0.148 kg	Weight

Dimensions

C	20 mm	Width, outer ring
d_2	31.5 mm	Outside diameter of thrust washer
r_{min}	1 mm	Minimum chamfer dimension
R	500 mm	Radius of outer ring outside profile